

RÖSHULTS

Fco. Javier Burillo Palacín
Master of Industrial Design



JONKÖPING UNIVERSITY
School of Engineering

USER NEEDS

1. Insert

A close-up photograph of a pizza being prepared on a metal tray. The pizza is topped with a red tomato sauce, melted cheese, sliced mushrooms, and fresh basil leaves. A person's hand is visible at the top, holding the edge of the pizza.

2. Manipulate

A photograph showing a person from behind, wearing a white t-shirt, using a long-handled metal peel to move a pizza into a stone oven. The oven is built into a brick wall and has a fire burning inside. The person is holding the handle of the peel with both hands.

3. Extract

A photograph showing a pizza being extracted from a stone oven. The pizza is on a metal tray and is being held by a person's hand. The oven is built into a brick wall and has a fire burning inside. The pizza is being moved out of the oven.

PIZZA PEEL

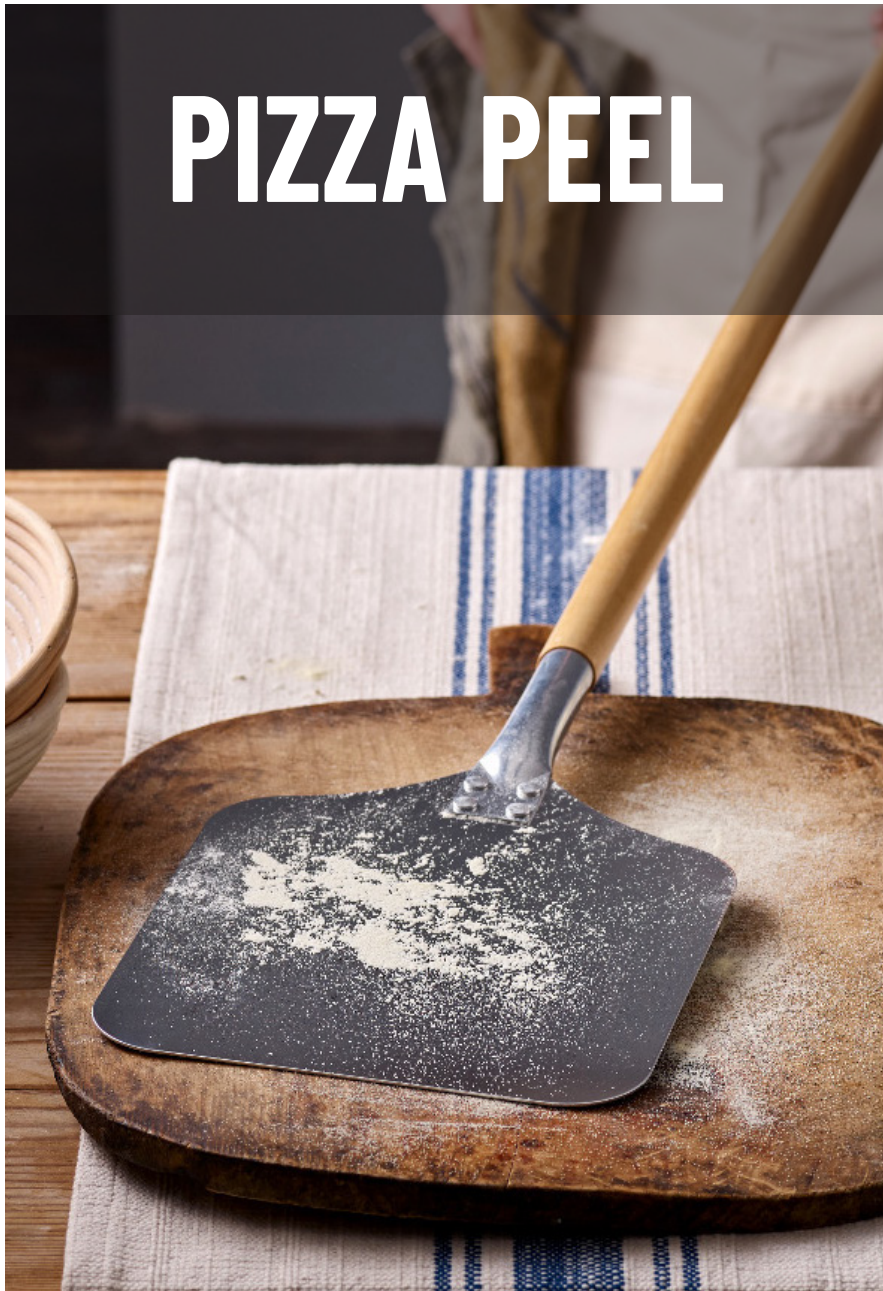

TURNING PEEL





Nonstick

Thick

Scratches and burns

VS



Adherent without holes

Thin

Less wear

IDENTIFY

GEOMETRY



MODULARITY



MATERIALS



DIMENSIONS

PIZZA PEEL

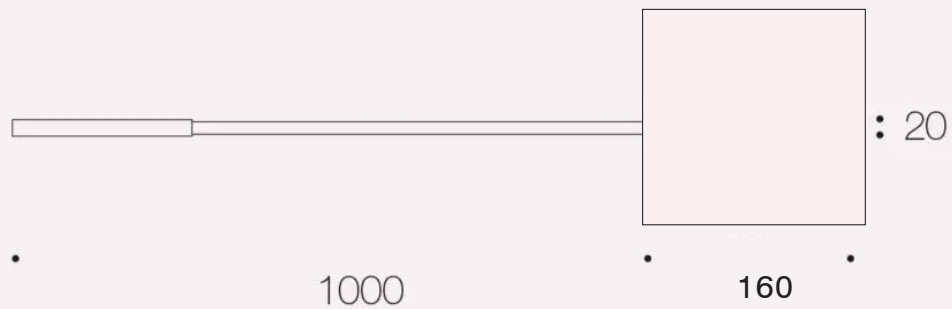

DIMENSIONS

TURNING PEEL



FEATURINGS



CONCEPTS



C1.



C2.

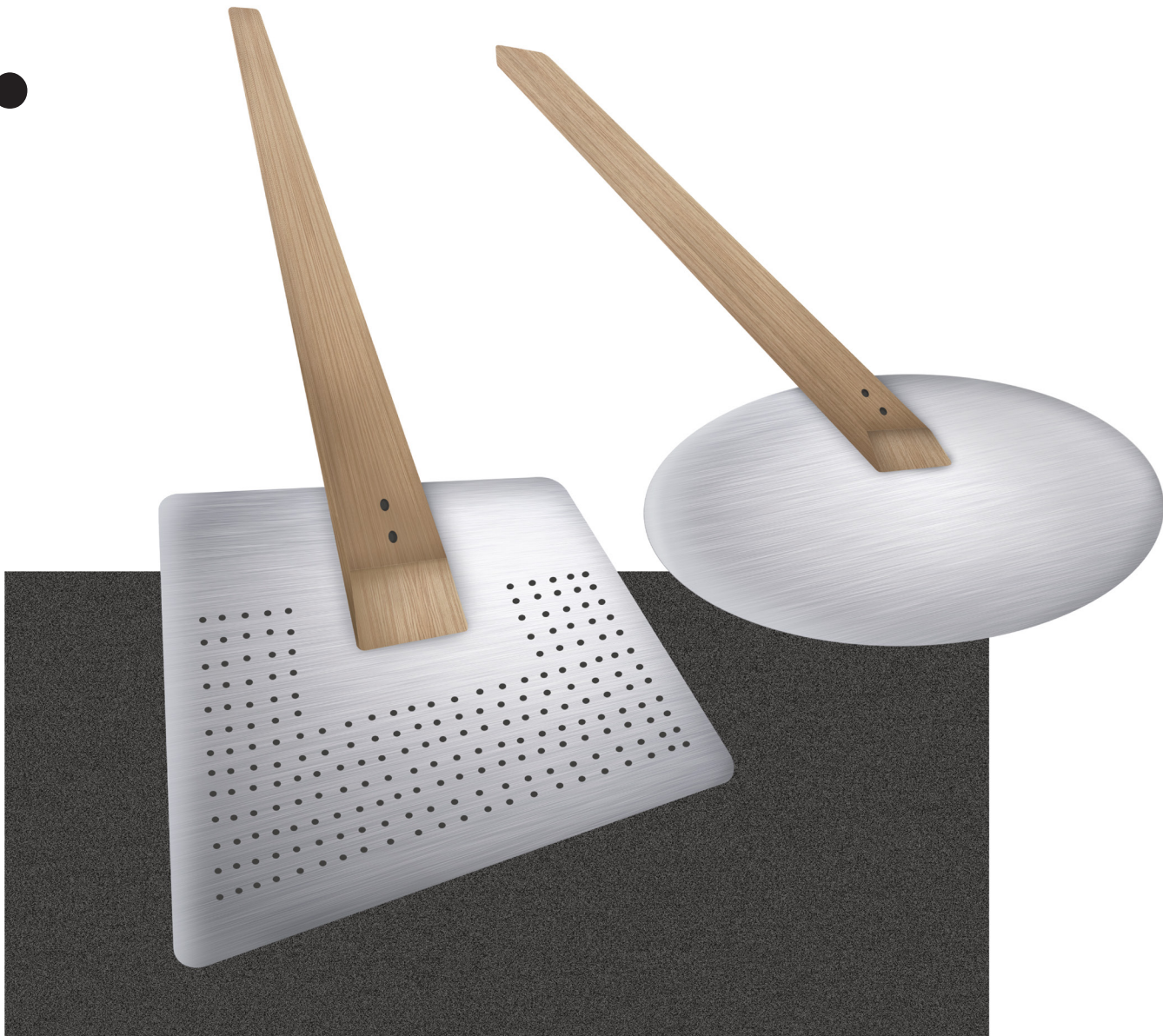

C1.

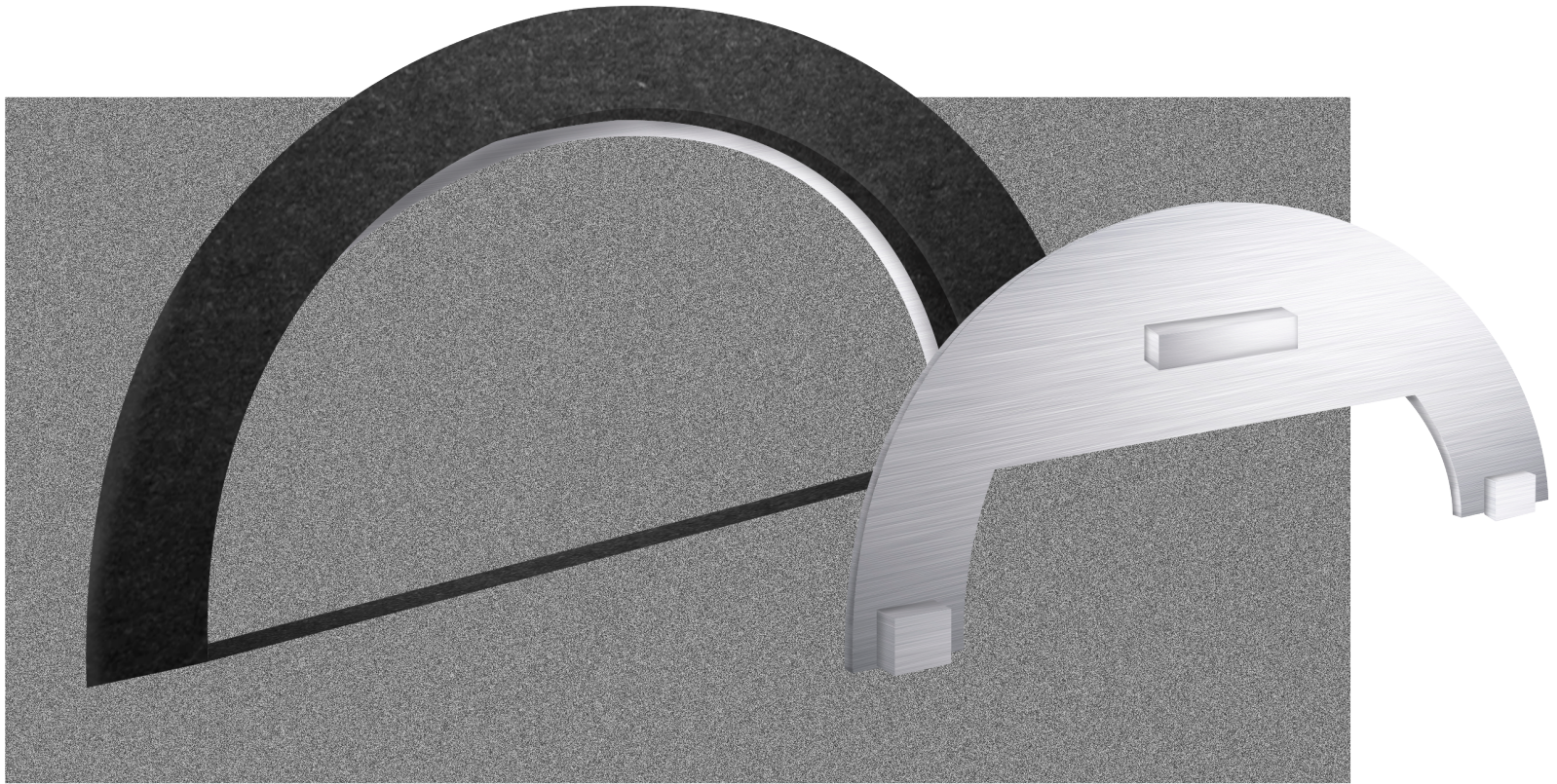

C2.

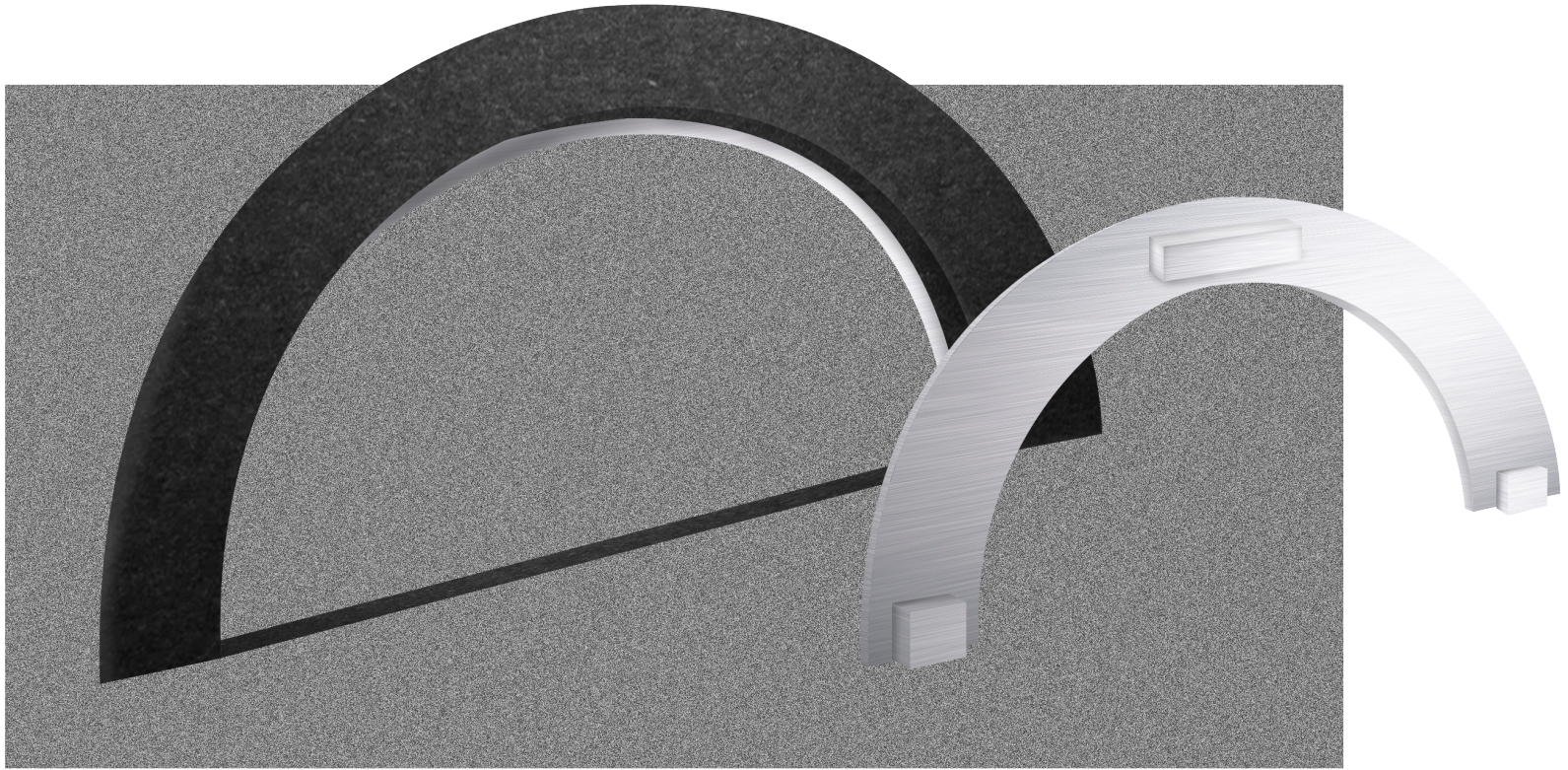

RÖSHULTS

Fco. Javier Burillo Palacín
Master of Industrial Design



JONKÖPING UNIVERSITY
School of Engineering